

CHANGE NO	REV	DESCRIPTION	APPD	DATE
ECO-019854	A	INITIAL RELEASE	AGILE	9/8/2014

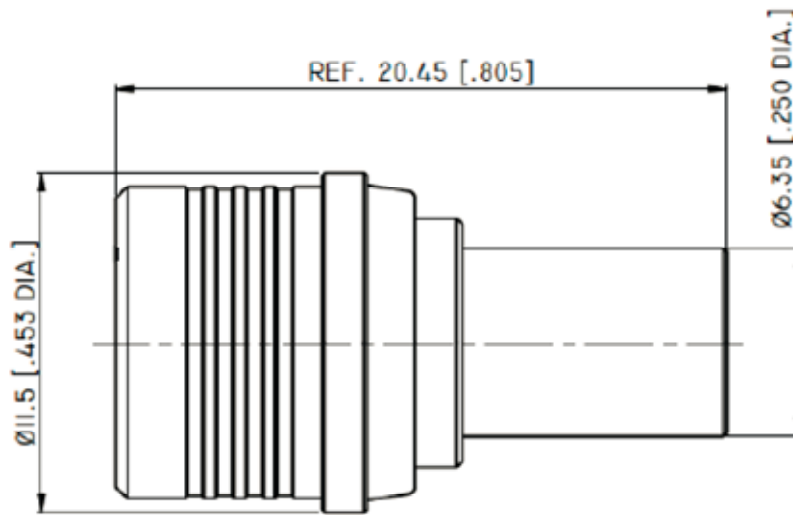

1. Electrical	Value
1.1 Impedance	50 Ohm
1.2 Frequency	DC to 6GHz
1.3 VSWR	1.20:1 Max
1.4 Insertion Loss	0.04dB x Sq.Rt.(FGHz)
1.5 Voltage Rating	250Vrms(Max.)
1.6 Insulation Resiatnce	>5,000MOhm
1.7 Center Contact Resistance	<6mOhms
1.8 Outer Contact Resistance	<2mOhms
1.9 Average Power	1 Watt
2. Environmental	
2.1 Temperature Range	-55C to +125C
2.2 RoHS Status	Compliant
2.3 Durability	>500 Cycles

8	Cap	Brass	Tri-Metal
7	Resistor	1W	Natural
6	Gasket	Silicon Rubber	Red
5	Coupling Nut	Brass	Tri-Metal
4	Retaining Spring	Ph. Bronze	Natural
3	Contact	Brass	Gold
2	Insulator	PTFE	White
1	Body	Brass	Tri-Metal
ITEM	DESCRIPTION	MATERIALS	FINISH

RoHS COMPLIANCE
 THE ITEM(S) ON THIS DRAWING MUST COMPLY WITH THE RoHS DIRECTIVE. REFER TO THE LATEST REVISION OF WESTELL DOCUMENT CORP-125 FOR DETAILS.

UNLESS OTHERWISE SPECIFIED DIMENSIONS ARE IN INCHES. TOLERANCES ON 2 PLACE DECIMAL +/- .01 3 PLACE DECIMAL +/- .005

QMA Termination
 1 Watt

 **WESTELL**
 TECHNOLOGIES INC.

THIS DOCUMENT IS THE PROPERTY OF WESTELL INC. IT MAY NOT BE REPRODUCED OR COPIED WITHOUT THE WRITTEN PERMISSION OF WESTELL INC.

SCALE N/A	DRAWING SIZE A
DRAWN GEW	DATE 07-12-16

SHT 1 OF 1

CS48-999-620

REV
 A